



NH2XLgPV 1100V DC 125A-400A Photovoltaic Fuse 光伏熔断器



Standard/ 标准: IEC 60269-6, GB/T 13539.6

INTERRUPTING CAPACITY / 分断能力:
30,000 A at 1100V DC (Time Constant: 1-3ms)

Dimensions/ 尺寸:

Unit 单位: mm

Type: NH2XLgPV Part No.: 2XLgPV(amp rating)U11A/A2

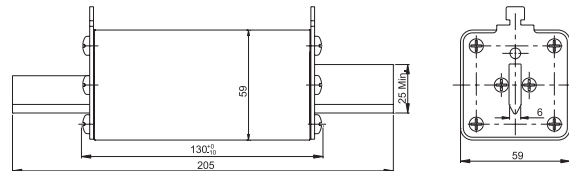

Type: NH2XLgPV-B Part No.: 2XLgPV(amp rating)U11B

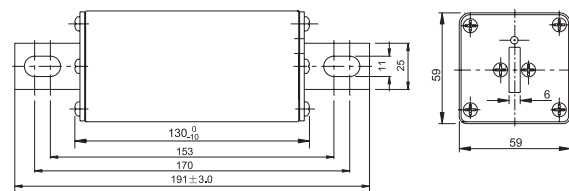

Type: NH2XLgPV-B Part No.: 2XLgPV(amp rating)U11BC

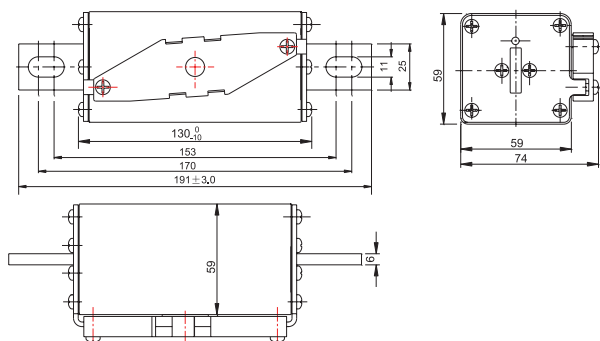

TECHNICAL PARAMETERS/ 技术参数:

PART NO. 目录编号	CURRENT RATING 额定电流	SAFETY APPROVALS 安全认证	
		TUV	
2XLgPV125U11A/A2	125A	●	●
2XLgPV125U11B/BC	125A	●	●
2XLgPV160U11A/A2	160A	●	●
2XLgPV160U11B/BC	160A	●	●
2XLgPV200U11A/A2	200A	●	●
2XLgPV200U11B/BC	200A	●	●
2XLgPV225U11A/A2	225A	●	●
2XLgPV225U11B/BC	225A	●	●
2XLgPV250U11A/A2	250A	●	●
2XLgPV250U11B/BC	250A	●	●
2XLgPV315U11A/A2	315A	●	●
2XLgPV315U11B/BC	315A	●	●
2XLgPV350U11A/A2	350A	●	●
2XLgPV350U11B/BC	350A	●	●
2XLgPV400U11A/A2	400A	●	●
2XLgPV400U11B/BC	400A	●	●

A- 触刀安装带中央指示器 blade contacts with the center indicator
 A2- 触刀安装带中央指示器和顶部指示器 blade contacts with the central indicator and the top indicator
 B- 螺栓连接 bolted connections
 BC- 螺栓连接带微动开关底座 bolted connections with microswitch base
 A、A2-optional 可选择
 B、BC-optional 可选择

U11 DENOTES FOR 1100V DC U11 表示 1100V DC
 ● DENOTES FOR APPROVAL ● 表示已取得安全认证
 ○ DENOTES FOR PENDING ○ 表示正在申请安全认证

NH2XLgPV 1100V 平均 I-T 曲线图 (仅供参考)
 AVERAGE I-T CHARACTERISTICS CURVE
 (FOR REFERENCE ONLY)

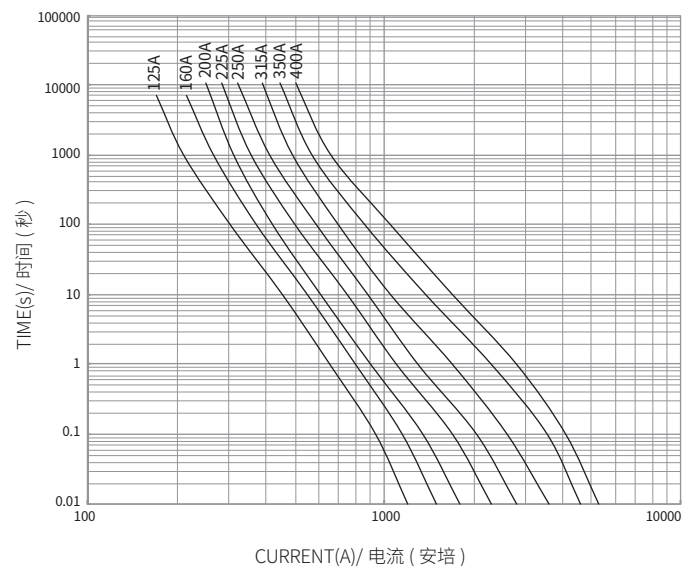

PART NO. 目录编号	Optional Accessory 可选配件	
	Fuse Holders 熔断器座	Microswitches 微动开关
2XLgPVXXU11A	NH3LBU11	/
2XLgPVXXU11A2	NH3LBU11	HMT-01
2XLgPVXXU11BC	/	HMC-01